

# SRC Series Part Numbering



## Features

- Bayonet Locking System
- Rugged
- Light-weight
- Low cost
- General purpose

## Applications

- Professional Audio / Video
- Vision Testing
- Factory Automation
- Measuring Equipment
- Medical

## Part Numbering

Product Number		Size	Number of Contacts	Suffix (Contact Type)	Optional Suffix	Notes
Series	Prefix (Body)				G	
SRC	6A	21	10,16,26	P	•	Plug (Male)
				S	•	Plug (Female)
	2A			P	•	Receptacle (Male)
				S	•	Receptacle (Female)
	A			PS	•	Adapter (Round)
	AP	PS	•	Adapter (Panel)		

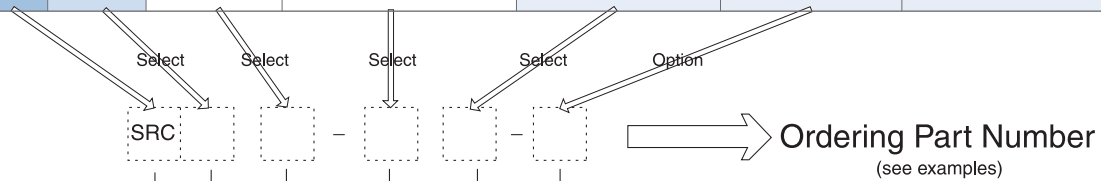

<b>Connector Series</b>
SRC6A - Plug
SRC2A - Receptacle
SRCA - Adapter (Round Type)
SRCAP - Adapter (Panel Type)
<b>Size</b>
21
<b>No. of Contacts</b>
10,16,26
<b>Contact Type</b>
P : Male
S : Female
PS : Male and Female
<b>Shell Type</b>
G : Gold plating contact

### Examples

SRC6A 21 - 10 P

SRC series Plug - Size 21 Plug - 10 Male Contact

SRC2A 21 - 16 S

SRC series Receptacle - Size 21 Receptacle - 16 Female Contact

SRCA 21 - 26 PS

SRC series Round Adapter - Size 21 Adapter - 26 Male & Female Contact

SRCAP 21 - 16 PS - G

SRC series Panel Adapter - Size 21 Adapter - 16 Male & Female Contact - Gold Plating Contact

Specifications subject to change without notice. Consult Sam Woo Electronics for the latest specifications.

■ Major Performances / Contact Arrangements

Performance	Size / No. of Contacts	Size 21		
		10	16	26
Withstanding Voltage (per min) <sup>1</sup>		AC 1000V	AC 1000V	AC 1000V
Current		10A	5A	5A / 10A
Insulation Resistance (Minimum) <sup>2</sup>		1,000M Ω	1,000M Ω	1,000M Ω
Contact Resistance (Maximum) <sup>3</sup>		5m Ω	5m Ω	5m Ω
Solder Pot Inside Diameter		∅ 1,5	∅ 1,0	∅ 1,0 / ∅ 1,5
Wire Gauge (Maximum)		AWG18	AWG20	AWG20 / AWG18
Contact Arrangement				

! <sup>1</sup> Withstanding voltage is the tested voltage value in this table.  
<sup>2</sup> Insulation resistance is measured at DC 100V.  
<sup>3</sup> Contact resistance is measured at DC 1A.  
 • Values are from tested items and may not apply to all connectors.  
 • Specifications subject to change without notice.  
 • Consult Sam Woo Electronics for the latest specifications.  
<sup>4</sup> Connector contact arrangement is from mating surface.

■ Material Used / Finish

	Material	Finish
Body	Alluminum alloy	Ni or Gold Plating
Insulator	Thermosetting resin	Black
Contacts	Male	Brass
	Female	Phosphor bronze

■ SRC Series Mini-map

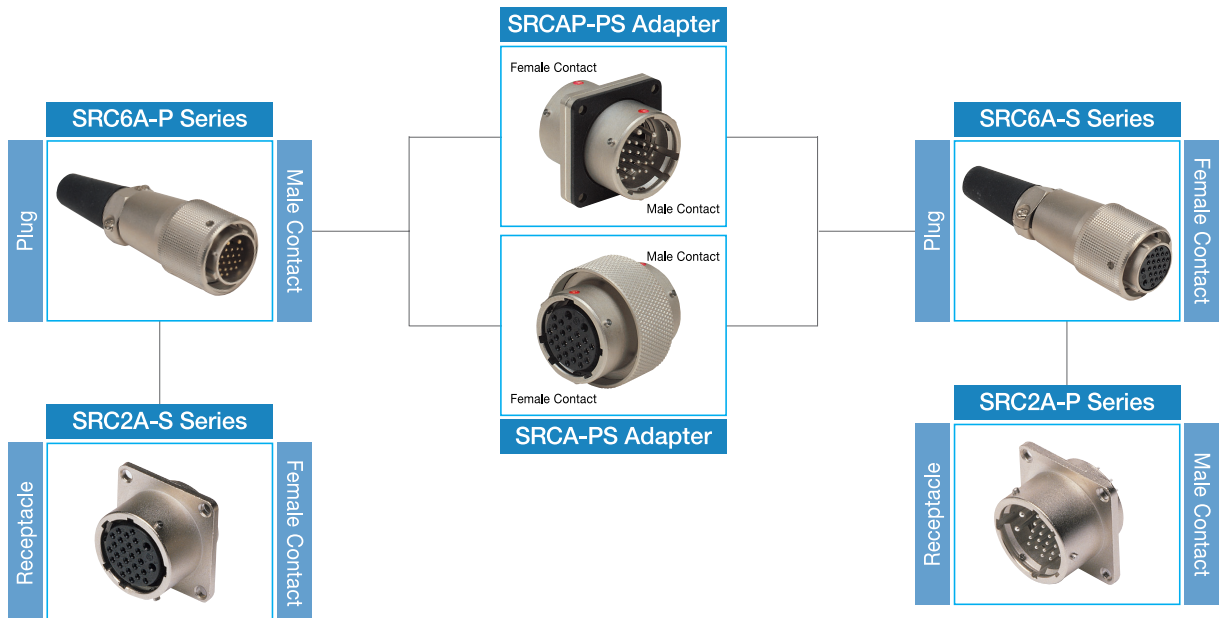

Specifications subject to change without notice. Consult Sam Woo Electronics for the latest specifications.

# SRC Series Male / Female Plug, Receptacle, Adapter

## ■ SRC6A Plug

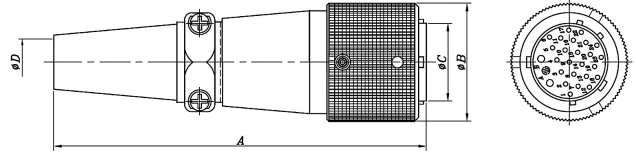

Product Number	A	∅ B	∅ C	∅ D
SRC6A21-10P	98,0	31,0	20,4	12,2
SRC6A21-16P				
SRC6A21-26P				
SRC6A21-10P-G				
SRC6A21-16P-G				
SRC6A21-26P-G				

## ■ SRC6A Plug



Product Number	A	∅ B	∅ C	∅ D
SRC6A21-10S	98,0	31,0	20,4	12,2
SRC6A21-16S				
SRC6A21-26S				
SRC6A21-10S-G				
SRC6A21-16S-G				
SRC6A21-26S-G				

## ■ SRC2A Receptacle



Product Number	∅ A	∅ B	C	D	E	F	G
SRC2A21-10P	25,6	23,6	26,4	14	2,3	32	26
SRC2A21-16P							
SRC2A21-26P							
SRC2A21-10P-G							
SRC2A21-16P-G							
SRC2A21-26P-G							

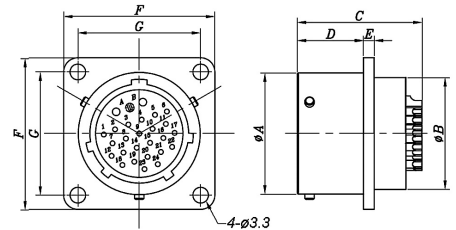

## ■ SRC2A Receptacle



Product Number	∅ A	∅ B	C(C')	D	E	F	G
SRC2A21-10S	25,6	23,6	27,7 (25,5)	14	2,3	32	26
SRC2A21-16S							
SRC2A21-26S							
SRC2A21-10S-G							
SRC2A21-16S-G							
SRC2A21-26S-G							

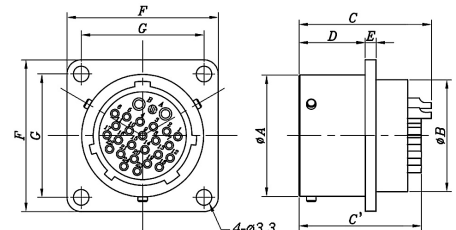

## ■ SRCAP Adapter (Panel, Male to Female)

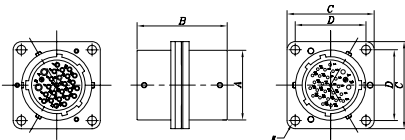

Product Number	∅ A	B	C	D	E
SRCAP21-10PS	25,6	33	32	26	4-∅3,3
SRCAP21-16PS					
SRCAP21-26PS					
SRCAP21-10PS-G					
SRCAP21-16PS-G					
SRCAP21-26PS-G					

## ■ SRCA Adapter (Round, Male to Female)

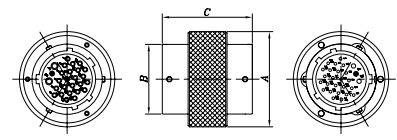

Product Number	∅ A	∅ B	C
SRCA21-10PS	35	25,6	35,0
SRCA21-16PS			
SRCA21-26PS			
SRCA21-10PS-G			
SRCA21-16PS-G			
SRCA21-26PS-G			

■ SRCAP Adapter (Panel, Male to Male)

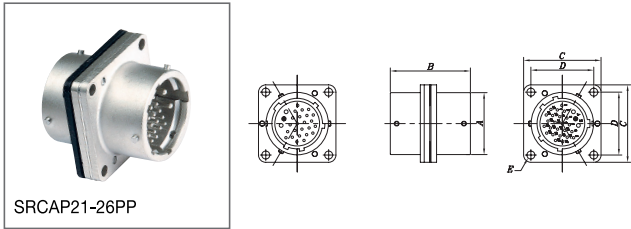

SRCAP21-26PP

Product Number	∅ A	B	C	D	E
SRCAP21-10PP	25,6	33	32	26	4 - ∅ 3,3
SRCAP21-16PP					
SRCAP21-26PP					
SRCAP21-10PP-G					
SRCAP21-16PP-G					
SRCAP21-26PP-G					

■ SRCAP Adapter (Panel, Female to Female)

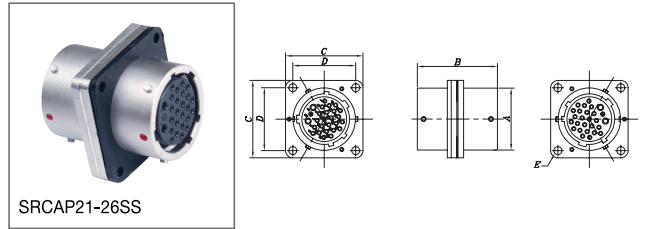

SRCAP21-26SS

Product Number	∅ A	B	C	D	E
SRCAP21-10SS	25,6	33	32	26	4 - ∅ 3,3
SRCAP21-16SS					
SRCAP21-26SS					
SRCAP21-10SS-G					
SRCAP21-16SS-G					
SRCAP21-26SS-G					

■ SRCA Adapter (Round, Male to Male)

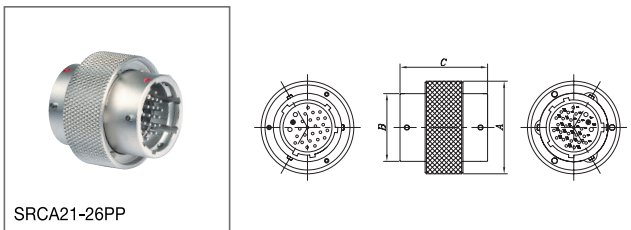

SRCA21-26PP

Product Number	∅ A	∅ B	C
SRCA21-10PP	35	25,6	35,0
SRCA21-16PP			
SRCA21-26PP			
SRCA21-10PP-G			
SRCA21-16PP-G			
SRCA21-26PP-G			

■ SRCA Adapter (Round, Female to Female)

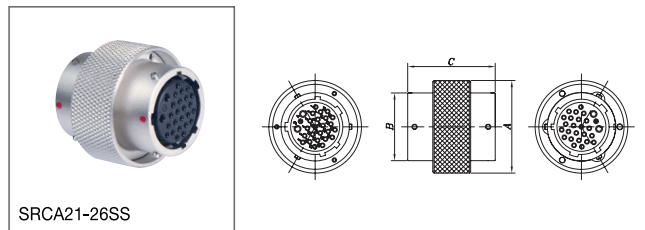

SRCA21-26SS

Product Number	∅ A	∅ B	C
SRCA21-10SS	35	25,6	35,0
SRCA21-16SS			
SRCA21-26SS			
SRCA21-10SS-G			
SRCA21-16SS-G			
SRCA21-26SS-G			



Specifications subject to change without notice. Consult Sam Woo Electronics for the latest specifications.



**Features**

- Bayonet Locking System
- Rugged
- Light-weight
- Low cost
- General purpose
- Standard and Custom Design

**Applications**

- Professional Audio / Video
- Vision Testing
- Factory Automation
- Measuring Equipment
- Medical

**Part Numbering**

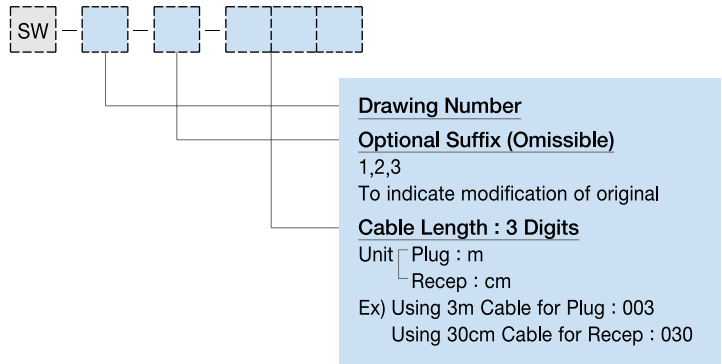

**Plug Cable Assembly**



Type	Construction
A	SRC Connector + Cable + Housing
B	SRC Connector + Cable + SRC Connector

※ Design and Customization Service Available

**Receptacle Cable Assembly**



Type	Construction
A	SRC Connector + wire + open end
B	SRC Connector + wire + Housing
C	SRC Connector + wire + Housing with core

※ Design and Customization Service Available

Specifications subject to change without notice. Consult Sam Woo Electronics for the latest specifications.