

# SB Series Triaxial



## Features

- High performance
- Rigorous design

## Applications

- Professional TV Camera
- Broadcasting Industry

### SB-101 Part Numbering (European Standard)



#### Body Type

- P : Plug
- PFC : Plug Fixed with Clamping Device
- PFC1 : Plug Fixed with Short Clamping Device
- J : Jack
- RC : Receptacle with Clamping Device
- RC1 : Receptacle with Short Clamping Device
- APJF : Adapter (Plug - Jack) Flange

#### Accessory Code

- 1,0 / 4,5 / 8,7
- 1,0 / 4,5 / 9,4
- 1,4 / 4,5 / 9,4
- 1,4 / 6,6 / 11,3
- 1,4 / 6,6 (for PFC1)

### SB-102 Part Numbering (American Standard)



#### Body Type

- P : Plug
- J : Jack

#### Accessory Code

- 0,81/3,7/9,5

### SB-770 Part Numbering (American Standard)



#### Body Type

- P : Plug
- J : Jack

#### Accessory Code

- 0,81/3,7/9,2
- 1,63/7,9/13,2

### Major Performances

Specification	101 Model	102 Model	770Model
Impedance	75 Ω	75 Ω	75 Ω
VSWR	<1,2 upto 1,5GHz	<1,2 upto 1GHz	<1,2 upto 1GHz
Contact Resistance	<3m Ω	<3m Ω	<1m Ω
Operating Temperature	-55℃ ~ +135℃	-55℃ ~ +135℃	-20℃ ~ +70℃

### Material Used / Finish

Material	101 Model	102 Model	770Model
Body	Brass (Ni & Chrome III Plating)	Brass (Ni & Chrome III Plating)	Brass (Ni & Chrome III Plating)
Contacts	Brass (Gold Plating)	Brass (Gold Plating)	Brass (Gold Plating)
Insulator	PTFE	PTFE	PTFE
Latching Sleeve	Brass (Ni Plating)	Brass (Ni Plating)	Beryllium copper (Ni Plating)
Seal	Silicon Rubber	Silicon Rubber	Silicon Rubber

■ SB Series Mini-map (European Standard)

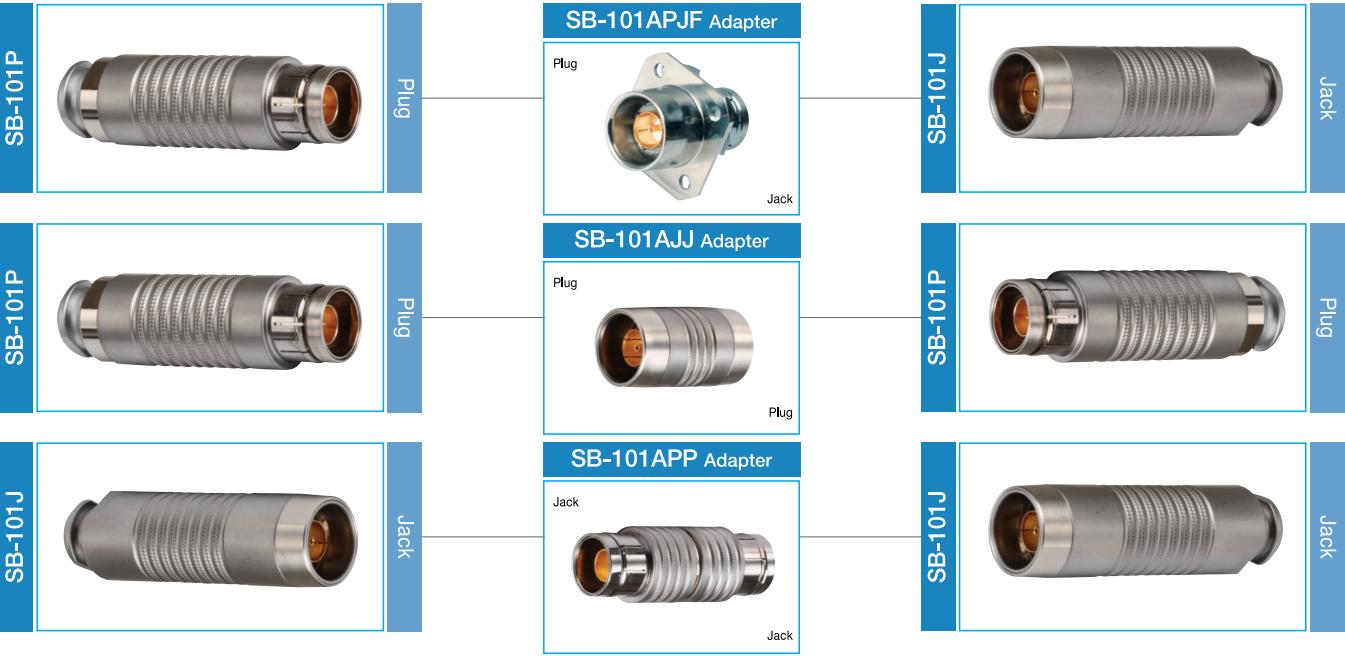
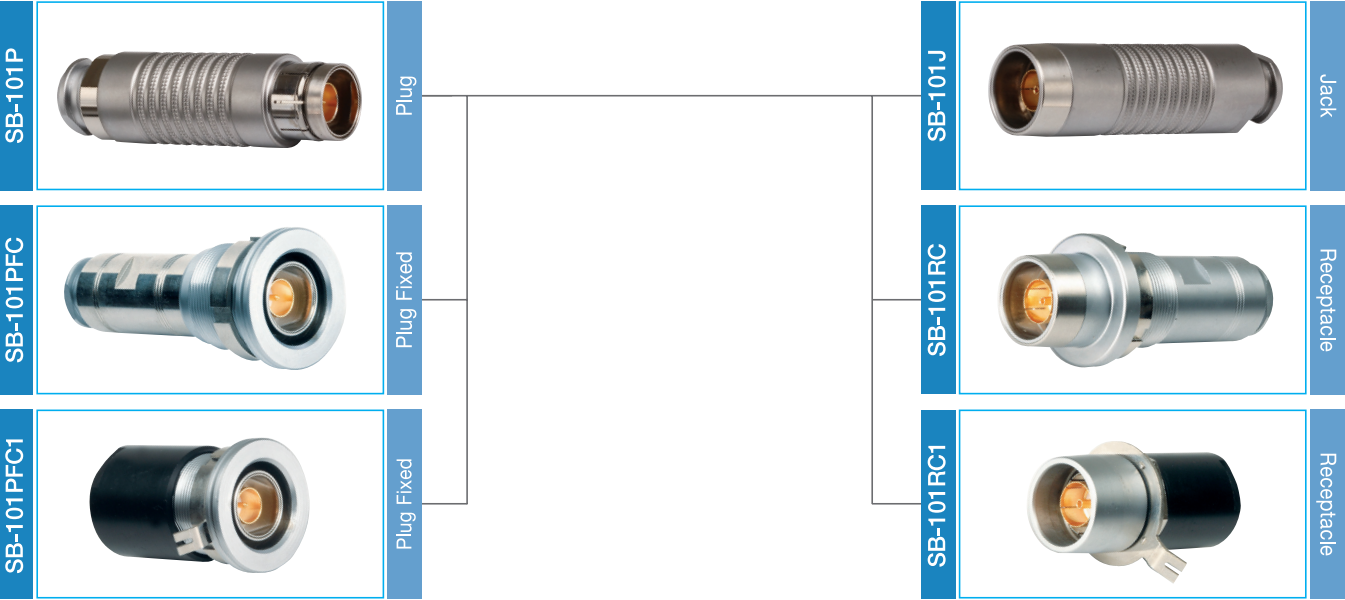

■ SB Series Mini-map (American Standard)

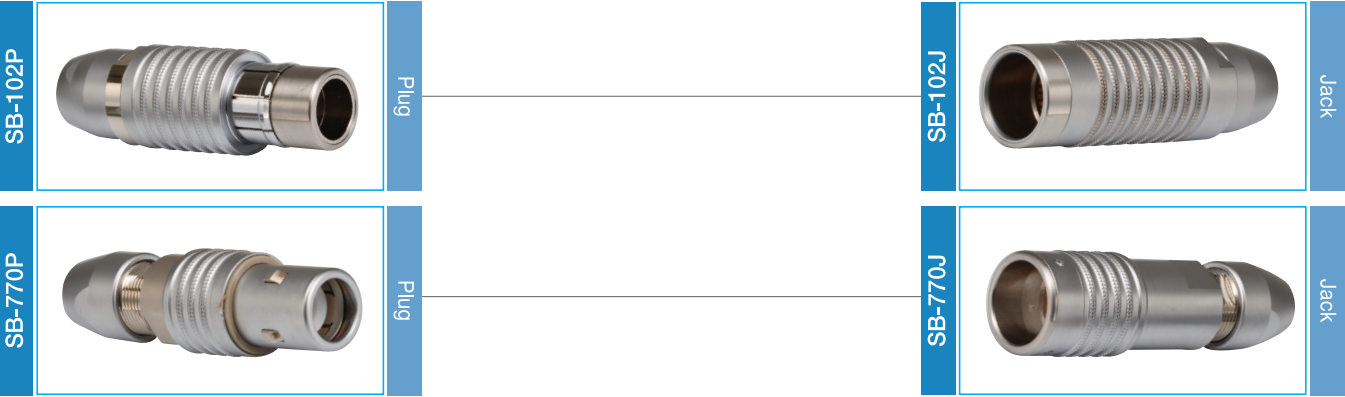

Specifications subject to change without notice. Consult Sam Woo Electronics for the latest specifications.

# SB Series Triaxial

## SB-101 Model (European Standard)

Includes accessories,  
Accessories available separately.

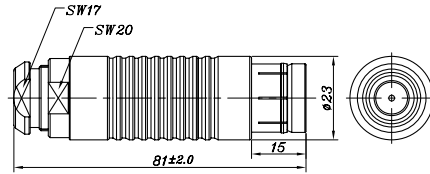
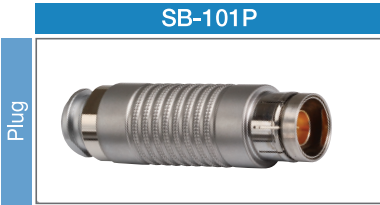

### Product Number

- SB-101P-1,0/4,5/8,7
- SB-101P-1,0/4,5/9,4
- SB-101P-1,4/4,5/9,4
- SB-101P-1,4/6,6/11,3

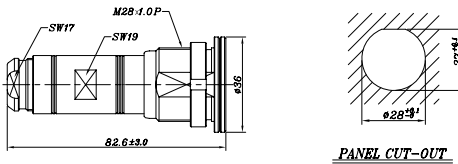
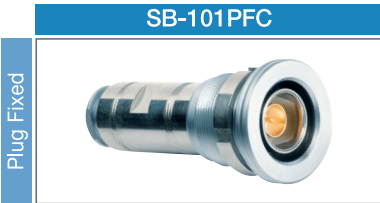

### Product Number

- SB-101PFC-1,0/4,5/8,7
- SB-101PFC-1,0/4,5/9,4
- SB-101PFC-1,4/4,5/9,4
- SB-101PFC-1,4/6,6/11,3

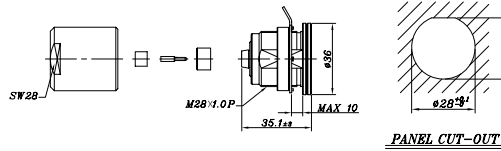

### Product Number

- SB-101PFC1-1,4/6,6

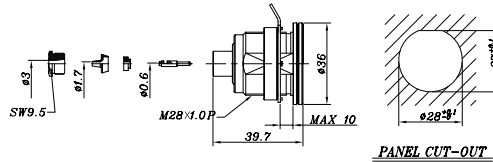
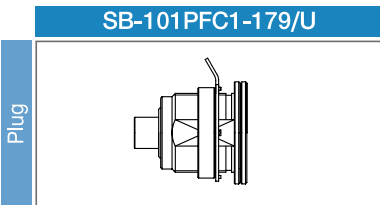

### Product Number

- SB-101PFC1-179/U
- Plug for cable assembly

### Product Number

- SB-101J-1,0/4,5/8,7
- SB-101J-1,0/4,5/9,4
- SB-101J-1,4/4,5/9,4
- SB-101J-1,4/6,6/11,3

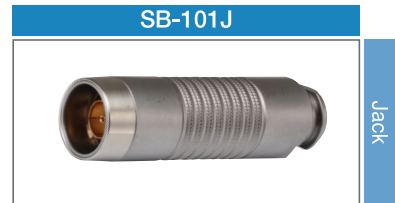
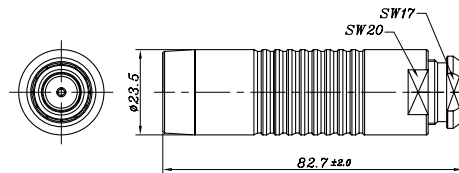

### Product Number

- SB-101RC-1,0/4,5/8,7
- SB-101RC-1,0/4,5/9,4
- SB-101RC-1,4/4,5/9,4
- SB-101RC-1,4/6,6/11,3

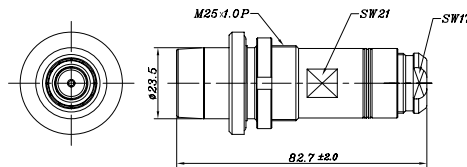

### Product Number

- SB-101RC1-1,4/6,6

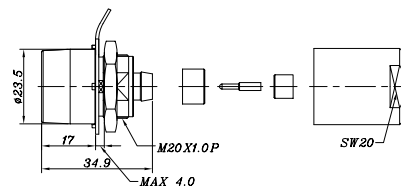

### Product Number

- SB-101RC1-179/U
- Receptacle for cable assembly

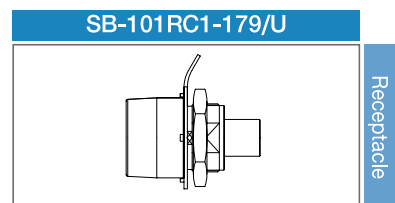
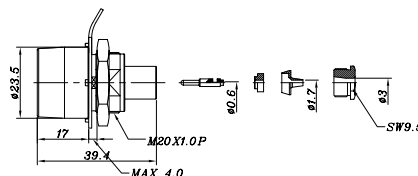

Specifications subject to change without notice. Consult Sam Woo Electronics for the latest specifications.

■ **SB-101 Model (European Standard)**

Adapter

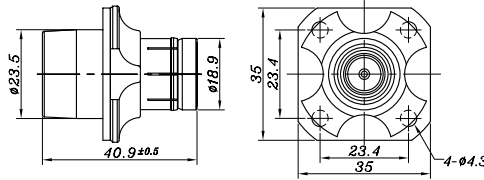

**Product Number**  
SB-101APJF  
Adapter : Jack

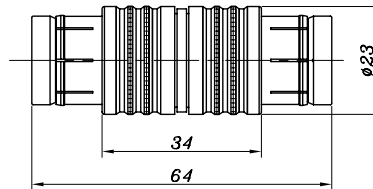

**Product Number**  
SB-101APP  
Adapter : Jack + Jack

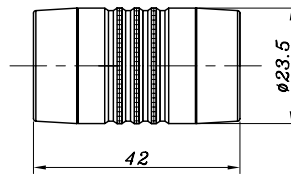

**Product Number**  
SB-101AJJ  
Adapter : Plug + Plug

■ **SB-102 Model (American Standard)**

Includes accessories,  
Accessories available separately.

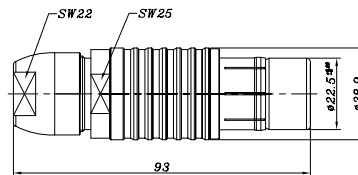

**Product Number**  
SB-102P-0,81/3,7/9,5

**Product Number**  
SB-102J-0,8/3,7/9,5

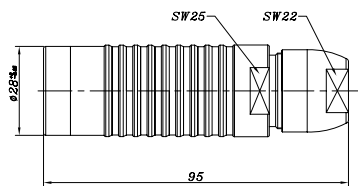

■ **SB-770 Model (American Standard)**

Includes accessories,  
Accessories available separately.

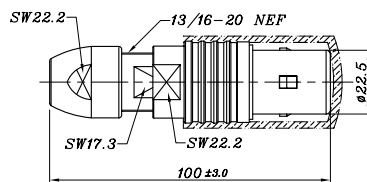

**Product Number**  
SB-770P-0,81/3,7/9,2  
SB-770P-1,63/7,9/13,2

**Product Number**  
SB-770J-0,81/3,7/9,2  
SB-770J-1,63/7,9/13,2

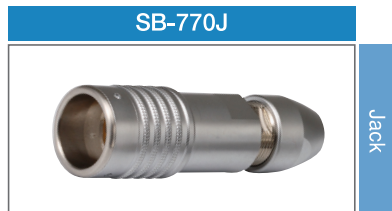
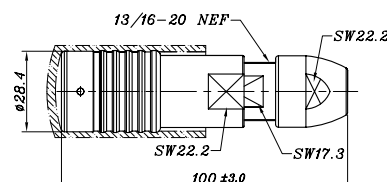

Specifications subject to change without notice. Consult Sam Woo Electronics for the latest specifications.

# SB Series Accessories(Triaxial)

## SB-101 Accessory

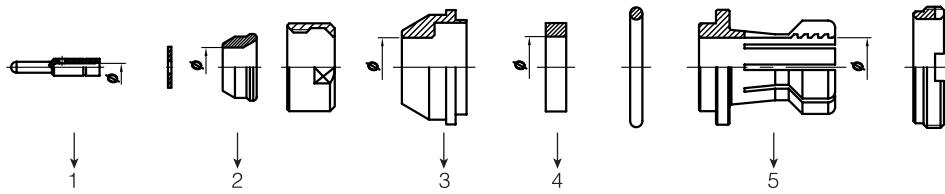

Product Number	Diameter( $\phi$ )				
	1	2	3	4	5
SB-101-1,0 / 4,5 / 8,7A	1,15	5,8	8,7	8,8	8,7
SB-101-1,0 / 4,5 / 9,4A	1,15	5,8	9,4	9,4	9,4
SB-101-1,4 / 4,5 / 9,4A	1,5	5,8	9,4	9,4	9,4
SB-101-1,4 / 6,6 / 11,3A	1,5	7,5	11,3	10,3	11,3

## SB-102 Accessory

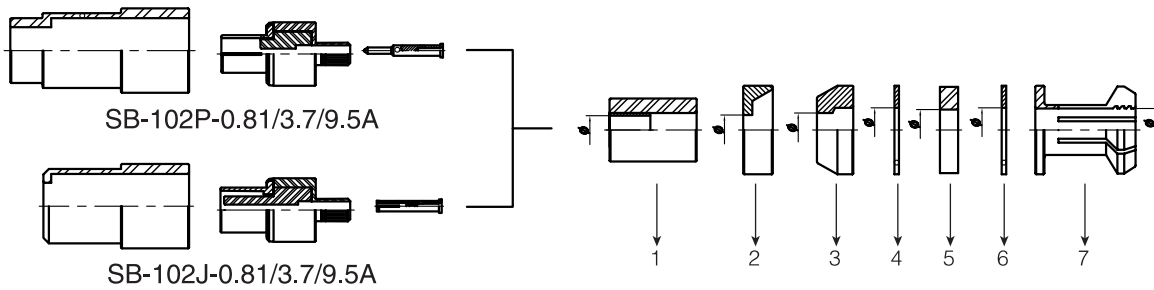

Product Number	Diameter( $\phi$ )						
	1	2	3	4	5	6	7
SB-102P-0,81/3,7/9,5A	6,3	6,6	7,5	9,8	9,0	9,8	9,5
SB-102J-0,81/3,7/9,5A							

## SB-770 Accessory

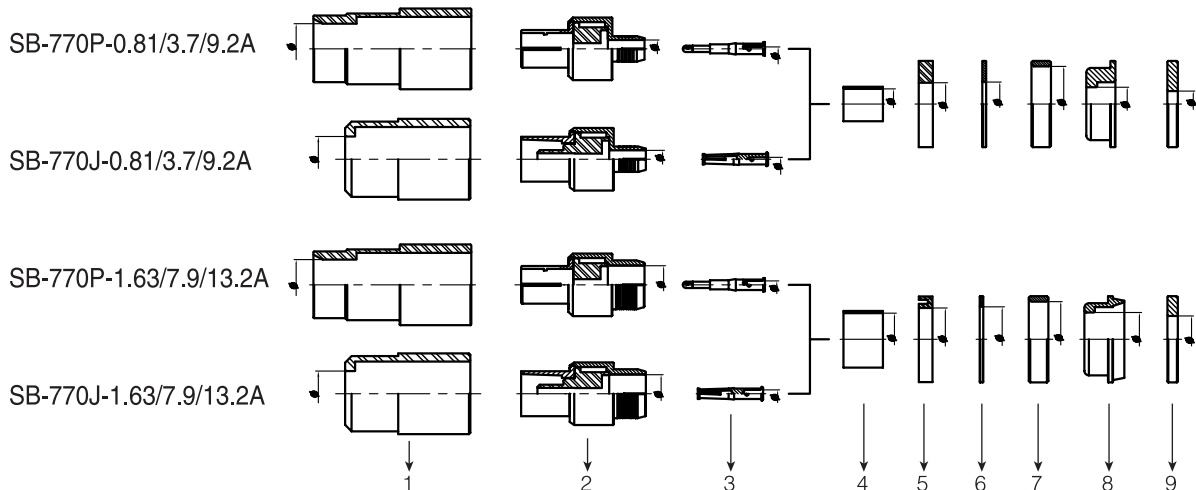

Product Number	Diameter( $\phi$ )								
	1	2	3	4	5	6	7	8	9
SB-770P-0,81/3,7/9,2A	11,1	3,9	0,85	6,7	9,4	9,7	16,65	7,4	5,7
SB-770J-0,81/3,7/9,2A				10					
SB-770P-1,63/7,9/13,2A	11,1	8,4	1,7	11,5	13,8	14,3	16,65	11,8	10,3
SB-770J-1,63/7,9/13,2A				10					

Specifications subject to change without notice. Consult Sam Woo Electronics for the latest specifications.

### ■ SB-101P BOOT

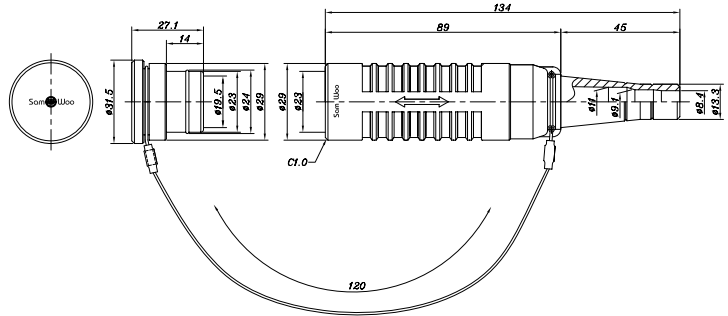
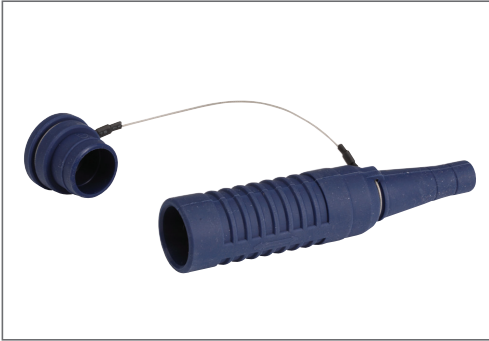

### ■ SB-101J BOOT

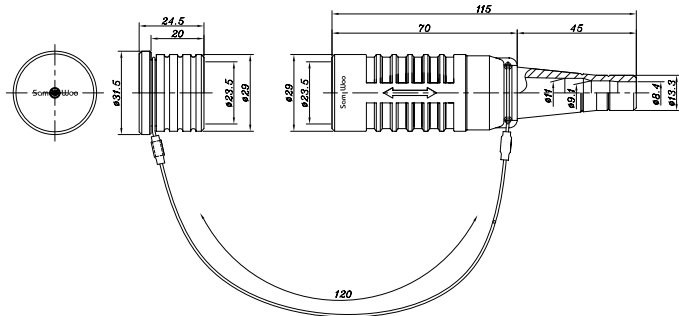
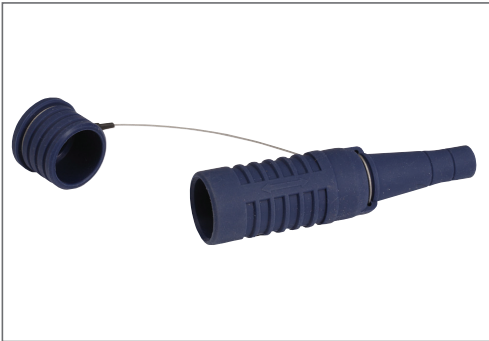

### ■ SB-101J CAP

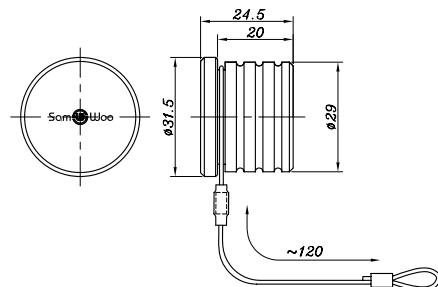
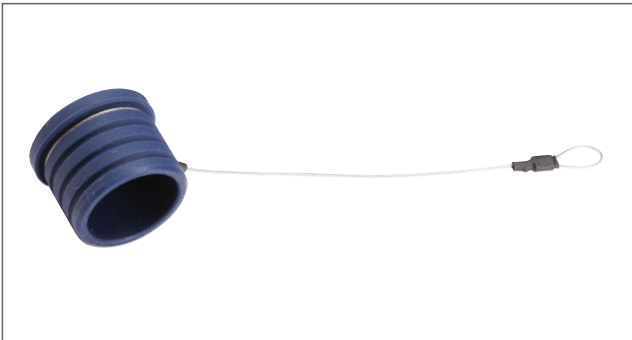

### ■ SB-101P CAP

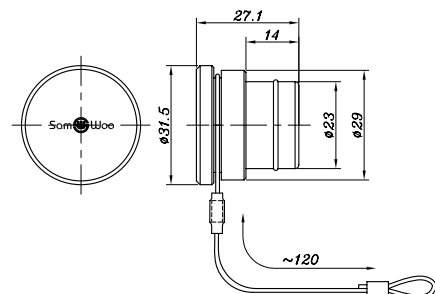
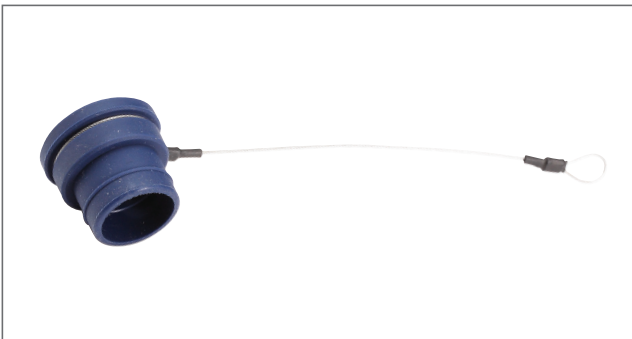

## SB-101 Model (European Standard)

### ■ SB-101J & SB-101P

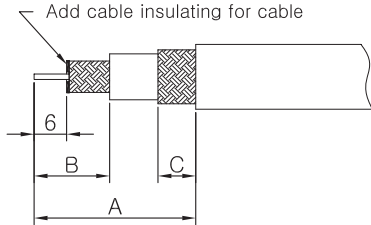

REF.	A	B	C
SB-101P+SB-101J-1,0/4,5	24	14	7
SB-101PFC+SB-101RC-1,0/4,5	25	14	7
SB-101P+SB-101J-1,4/4,5	27	12	7
SB-101PFC+SB-101RC-1,4/4,5	27	12	7
SB-101P+SB-101J-1,4/6,6	27	13	5
SB-101PFC+SB-101RC-1,4/4,6	27	13	5

#### A

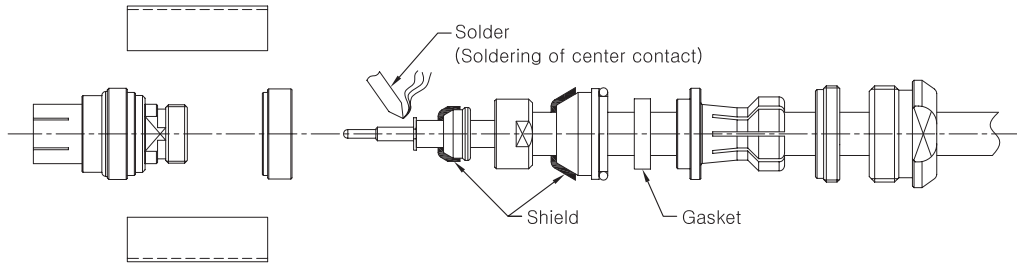

#### B

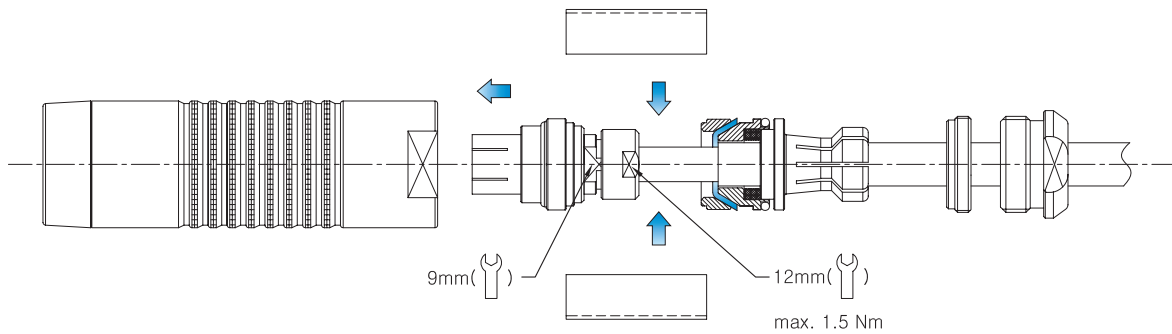

#### C

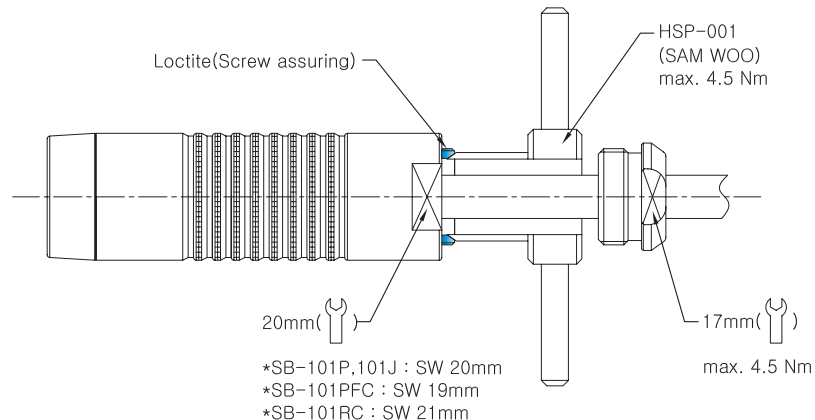

Specifications subject to change without notice. Consult Sam Woo Electronics for the latest specifications.

**SB-101 Model (European Standard)**

■ **SB-101RC1**

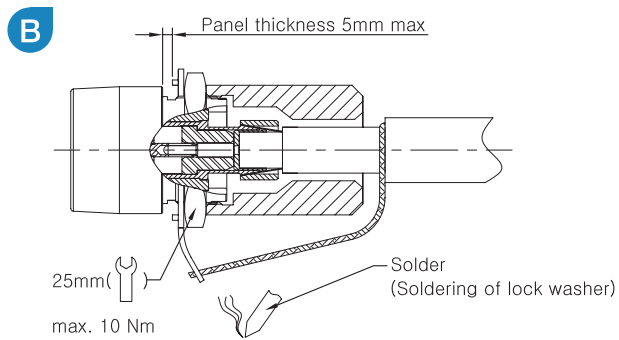
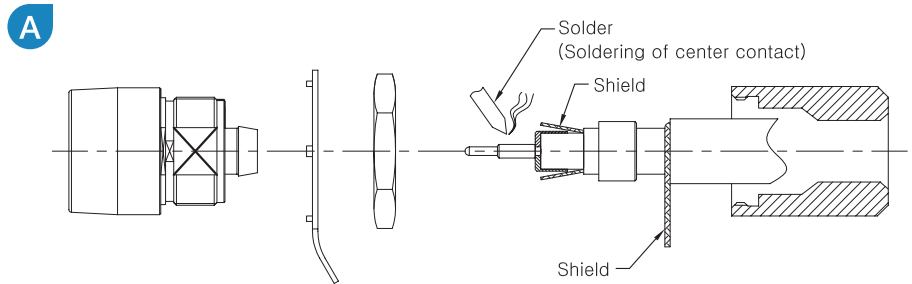
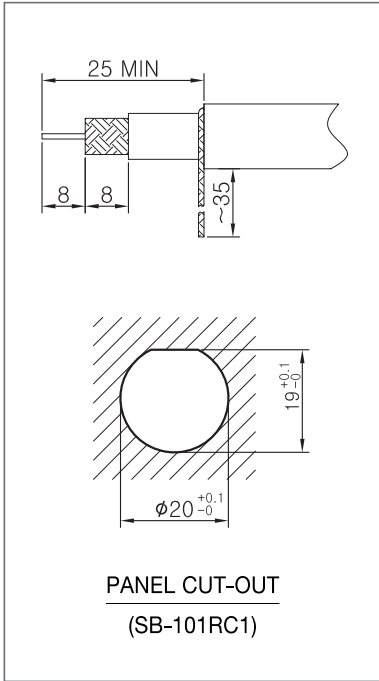

■ **SB-101PFC1**

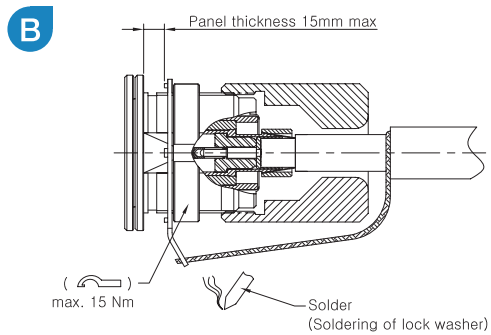
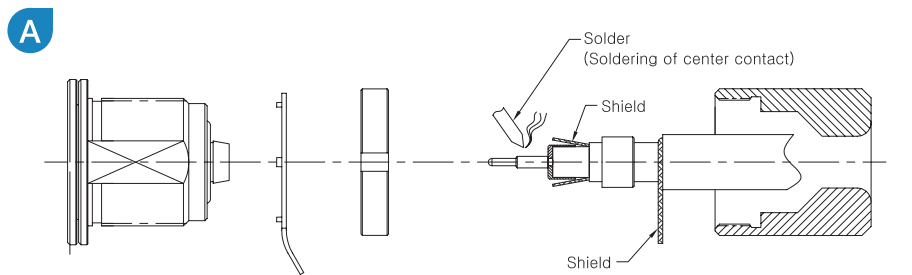
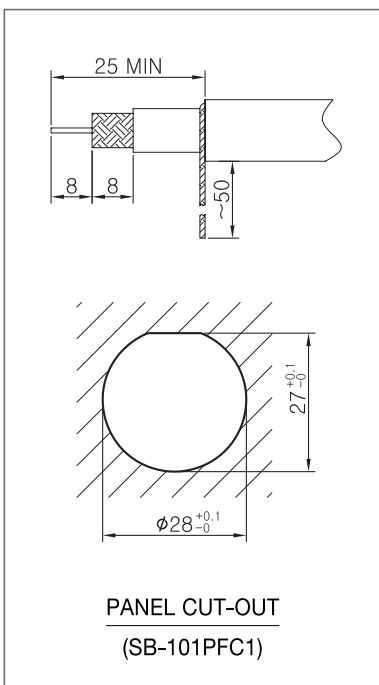

Specifications subject to change without notice. Consult Sam Woo Electronics for the latest specifications.



**SB-102 Model (American Standard)**

■ SB-102P & SB-102J

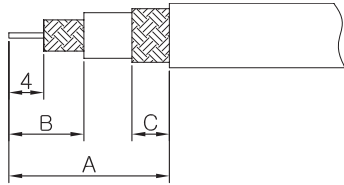

REF.	A	B	C
SB-102P-0,81/3,7/9,5	36	16	13
SB-102J-0,81/3,7/9,5	36	16	13

**A**

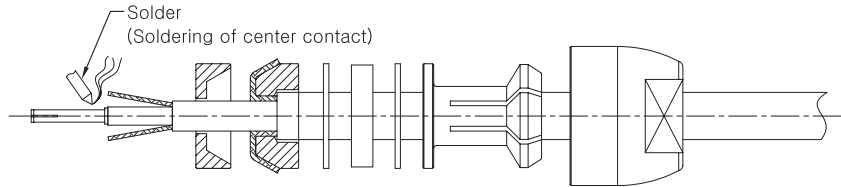

**B**

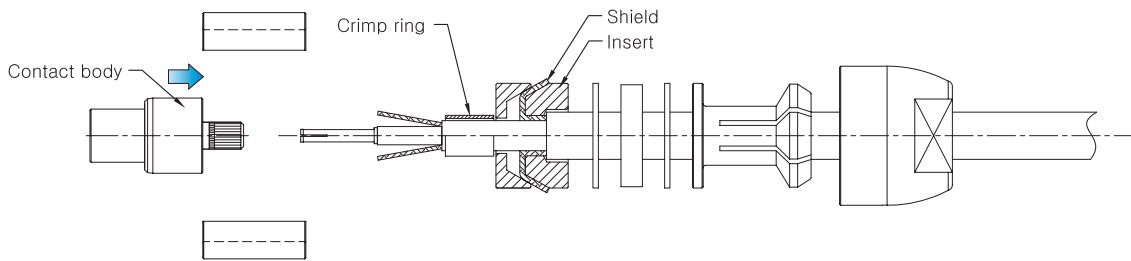

**C**

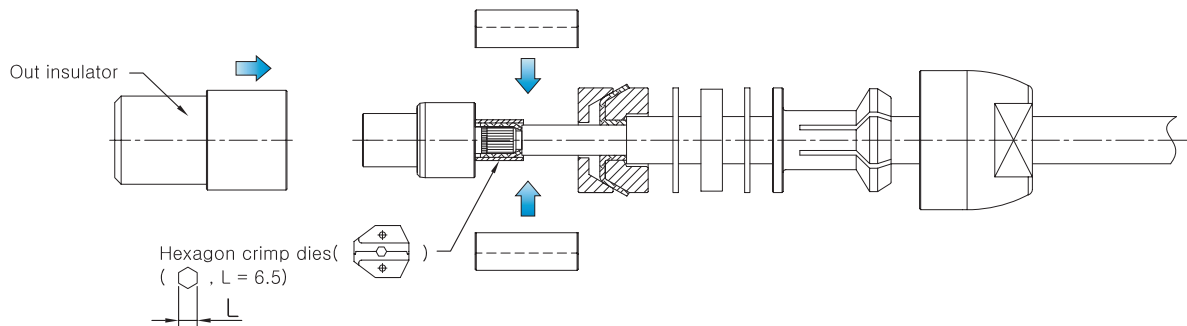

**D**

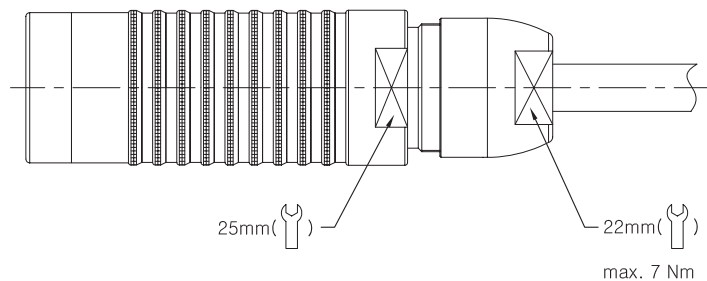

Specifications subject to change without notice. Consult Sam Woo Electronics for the latest specifications.

## SB-770 Model (American Standard)

### ■ SB-770P & SB-770J

1

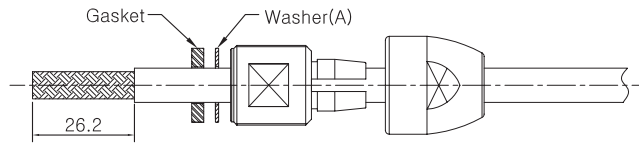

2

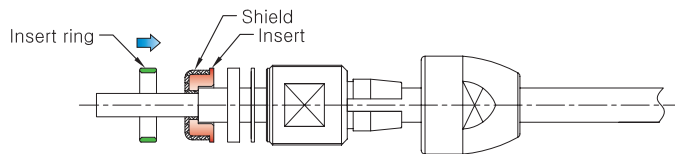

3

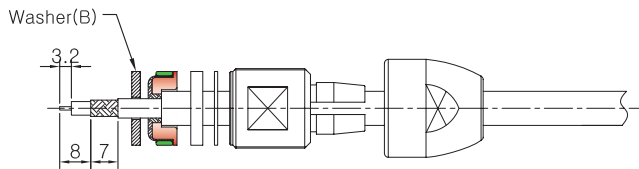

4

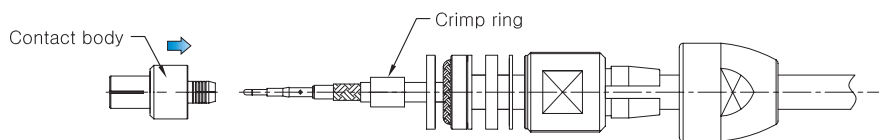

5

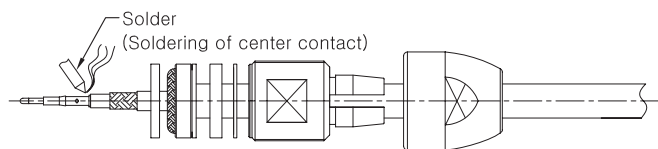

6

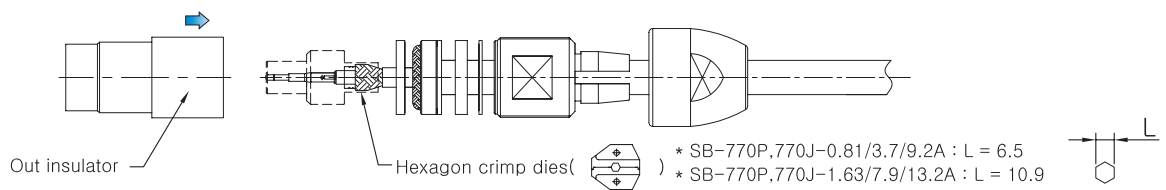

7

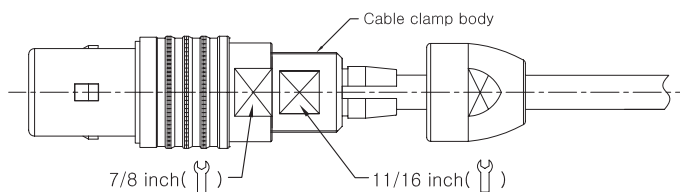

8

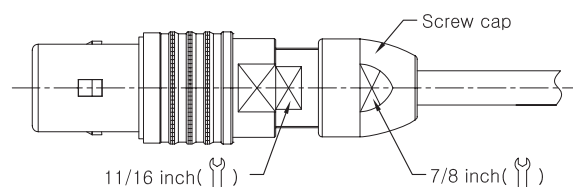

Specifications subject to change without notice. Consult Sam Woo Electronics for the latest specifications.

# SB Series Cable Assembly



## Features

- High performance
- Rigorous design
- Standard and Custom Design

## Applications

- Professional TV Camera
- Broadcasting Industry

## Part Numbering



**Drawing Number**  
**Optional Suffix (Omissible)**  
 1,2,3  
 To indicate modification of original  
**Cable Length : 3 Digits**  
 Unit Plug : m  
       Recep : cm  
 Ex) Using 3m Cable for Plug : 003  
       Using 30cm Cable for Recep : 030

## Plug Cable Assembly



Type	Construction
A	SB Connector + Cable + Housing
B	SB Connector + Cable + SB Connector

※ Design and Customization Service Available

## Jack Cable Assembly



Type	Construction
A	SB Connector + Cable + open end
B	SB Connector + Cable + Housing
C	SB Connector + Cable + Housing with core

※ Design and Customization Service Available

Specifications subject to change without notice. Consult Sam Woo Electronics for the latest specifications.